

look

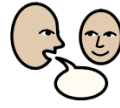

say



cover



write



check

I should already know

How to explain the course of a river
How to plan a journey

What is fair and unfair
What generosity is and how to show it

I will learn:

Religious Education

to respond thoughtfully to a range of sources of wisdom and to beliefs and teachings that arise from them in different religions and to look at the Bible, Torah and Qur'an as sources of wisdom for different communities. Respond to ideas from the text with ideas of their own.

Geography

To describe how some places are similar and dissimilar in relation to their human and physical features and use maps, aerial photographs, plans and e-resources to describe what a locality

Computing

To present information effectively using Sketchup

This will help in the future:

To explain and interpret ways that the history and culture of religions and world views influence individuals and communities

Design, use and evaluate computational abstractions that model the state and behaviour of real-world problems and physical systems

Geography

biodiversity	
biome	
Riparian	
Desert scrub	
erosion	
basin	

Religious Education

creation	
wisdom	
sacred	
respond	

Thinking Deeper

How can Sketchup be used to show the impact climate change is having? Who will this help? Which professions would benefit from using Sketchup?

Geography – Grand Canyon



The Grand Canyon is found in the US state of Arizona. Many people consider it to be one of the seven wonders of the natural world. The Colorado River runs through the Grand Canyon, it has been eroding its steep sides for millions of years. There is a **riparian** (interface between land and a river or stream) **biome** at the bottom of the Canyon. At the top is a **desert scrub biome**: a place that's still very dry, but also quite full of various shrubs and animals that have developed unique ways to cope with drought.

Computing & Art

SketchUp is a 3D modelling computer program for a wide range of drawing applications such as architectural, interior design, landscape architecture, civil and mechanical engineering, film and video game design. We will use it to replicate the erosion that has occurred at the Grand Canyon.

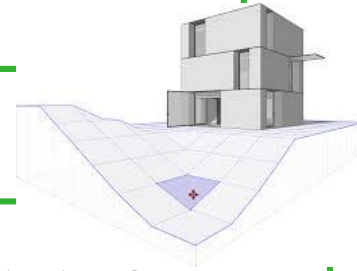

Religious Education

When people listen supportively through clarification, reflection, advising and probing, they **will respond thoughtfully**. Spiritual development enables people to increase their self awareness and to look at their human relationships, at the wider world and at their ideas about ultimate reality (for some people, God) with characteristics and values such as courage, hope, strength, insight and love.